

Technical specification for T-head bolts (ANSI/AWWA C111/A21.11)

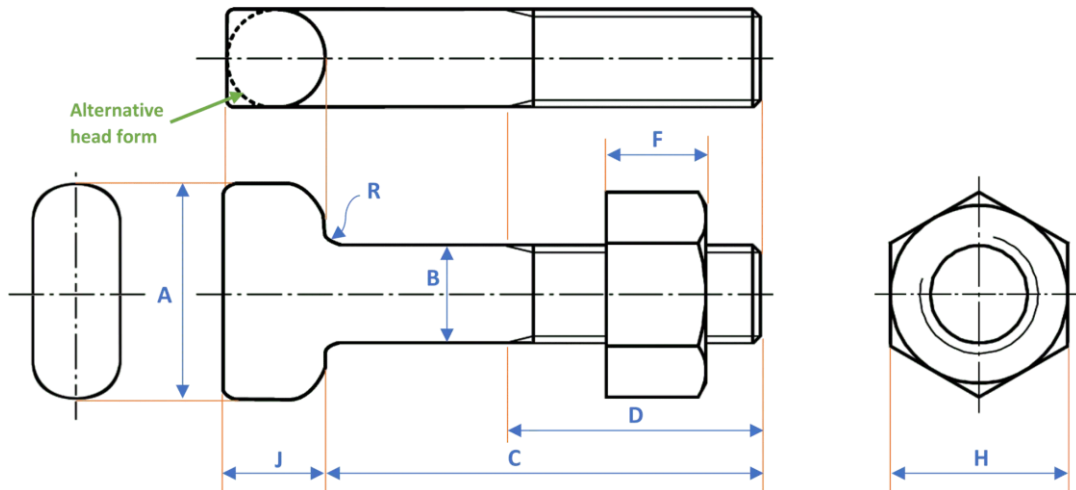

Dimensions of T-head (tee-head) bolt and nut

Size <i>in.</i>	A $\pm 0,05$	B $+0,030$ $-0,074$	C $+0,25$ $-0,05$	D* $+3$ -0	F	H $+0,00$ $-(\text{as spec.})$	J $+0,15$ $-0,03$	R max.
$\frac{5}{8} \times 3$	1,50	0,625	3,0	2,00	$0,625 \pm 0,04$	$1,062 - 0,04$	0,625	0,312
$\frac{3}{4} \times 3\frac{1}{2}$	1,75	0,750	3,5	2,50	$0,750 \pm 0,06$	$1,250 - 0,06$	0,750	0,375
$\frac{3}{4} \times 4$	1,75	0,750	4,0	3,00	$0,750 \pm 0,06$	$1,250 - 0,06$	0,750	0,375
$\frac{3}{4} \times 4\frac{1}{2}$	1,75	0,750	4,5	3,00	$0,750 \pm 0,06$	$1,250 - 0,06$	0,750	0,375
$\frac{3}{4} \times 5$	1,75	0,750	5,0	3,00	$0,750 \pm 0,06$	$1,250 - 0,06$	0,750	0,375
$1 \times 5\frac{1}{2}$	2,25	1,000	5,5	3,00	$1,000 \pm 0,08$	$1,625 - 0,08$	1,000	0,500
1×6	2,25	1,000	6,0	3,00	$1,000 \pm 0,08$	$1,625 - 0,08$	1,000	0,500
$1\frac{1}{4} \times 6$	2,50	1,250	6,0	3,50	$1,250 \pm 0,08$	$2,000 - 0,08$	1,250	0,625
$1\frac{1}{4} \times 6\frac{1}{2}$	2,50	1,250	6,5	3,5	$1,250 \pm 0,08$	$2,000 - 0,08$	1,250	0,625

*) Bolts with dimension C longer than listed above are assumed to use the same thread length requirements as the longest specified.

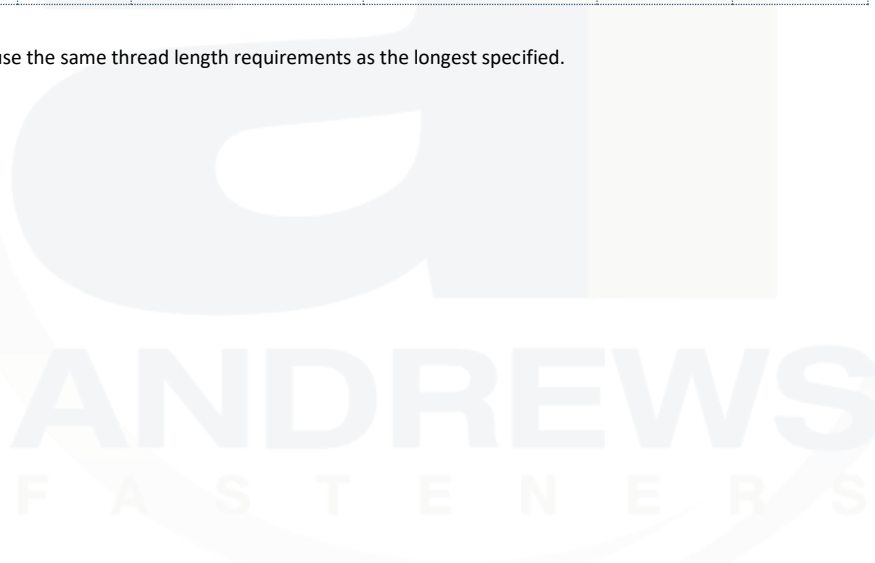

Chemical Properties

Component:	C	Mn	S	Ni	Cu	Ni+Cu+Cr
Min.	-	-	-	0,25	0,20	1,25
Max.	0,20	1,25	0,05	-	-	-

Mechanical Properties

Minimum yield strenght	45,000 psi (310 MPa)
Minimum elongation in 2 in.	20 %

Proof Load of bolt and nut

Bolt Size in.	Load (kN)	Load lbf
5/8	40,0	9 000
3/4	60,0	13 500
1	111,2	25 000
1 1/4	177,9	40 000

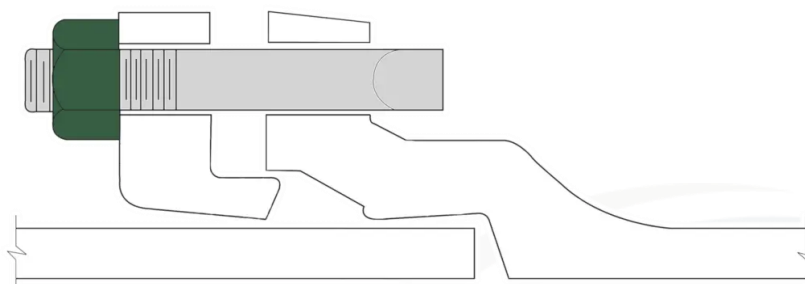

Torque Loads

Pipe size nom. in.	Bolt Size in.	Range of Torque (Nm)	Range of Torque lbf/ft	Length of Wrench in.	Length of Wrench* (mm)
3	5/8	61-81	45-60	8	203
4-24	3/4	102-122	75-90	10	254
30-36	1	136-163	100-120	14	256
42-48	1 1/4	163-203	120-150	16	406

*Applied with torque-measuring or torque-indicating wrenches.

Whilst the information is provided in good faith, Andrews Fasteners Ltd are not under any responsibility or liability in respect of errors or information that was found to be incorrect or for any reliance the user may place on it.